

UL RATED LEVEL I BULLET RESISTANT ACRYLIC INCLUDING WALL SECTIONS, WINDOWS & VERTICAL SUPPORTS

1" x 4" ALUM. TUBE (TOP & SIDES)

ALUM. U-CHANNEL (TOP & BOTTOM & SIDES)

14" x 8" x 1 1/2"

RECESSED DEAL TRAY

48" x 18" x 1 1/2" COUNTER

1
A1

ELEVATION

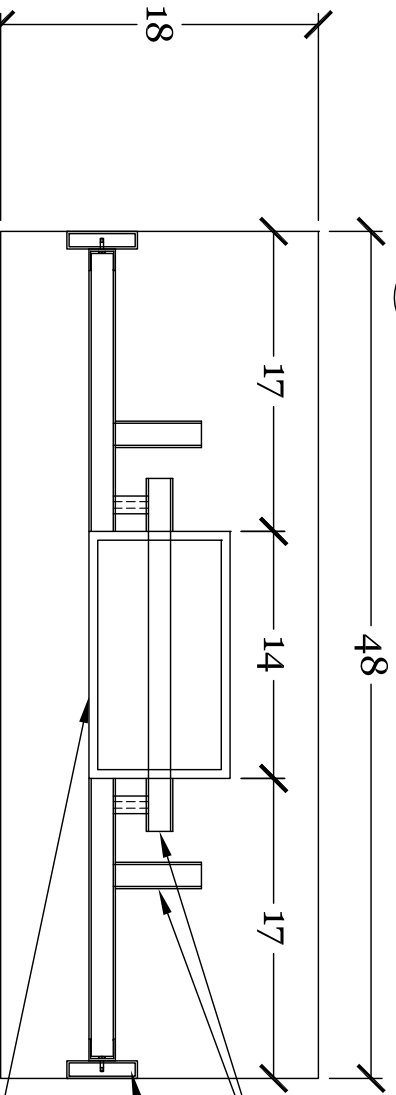

ALUM. 2-PC CHANNEL (TOP & BOTTOM & SIDES)

1" x 4" ALUM. TUBE (TOP & SIDES)

14" x 8" x 1 1/2"

RECESSED DEAL TRAY

2
A1

PLAN

Project Name:

ALUMINUM TRANSACTIONS WINDOW

TYPICAL DETAILS

Total Security Solutions

170 National Park Drive
Fowlerville, Michigan 48836
517.223.7807 Fax: 517.223.0805

These drawings and all information hereon are of a confidential nature and remain the property of TOTAL SECURITY SOLUTIONS. Any use or reproduction of these drawings for any purpose, except by written permission of TOTAL SECURITY SOLUTIONS is strictly prohibited.

Checked By:

Drawn By:

Created By:

Sheet Title:

Sheet Number:

A1